

ITEM NO.	PART NUMBER	DESCRIPTION	QTY.
1	20-200-9	BUSHING, EPOXY	1
2	ST-4025-14	CONDUCTOR, 3000A, 2 1/2"-12UNC BOTH ENDS	1
3	GA-0104-00	NITRILE BUNA N DUROMETER 60+/-5	1

REVISIONS					
REV.	DATE	ECN#	DESCRIPTION	BY	APPROVED
1	5/21/2009		UPDATED TO HJI TEMPLATE, ADDED GASKET & BOM, TOL. BELOW FLANGE WAS ±.06"		DB
2	6/23/2014	HJ14-108	REMOVED MAXIMUM CONDITION	CLS	BLB

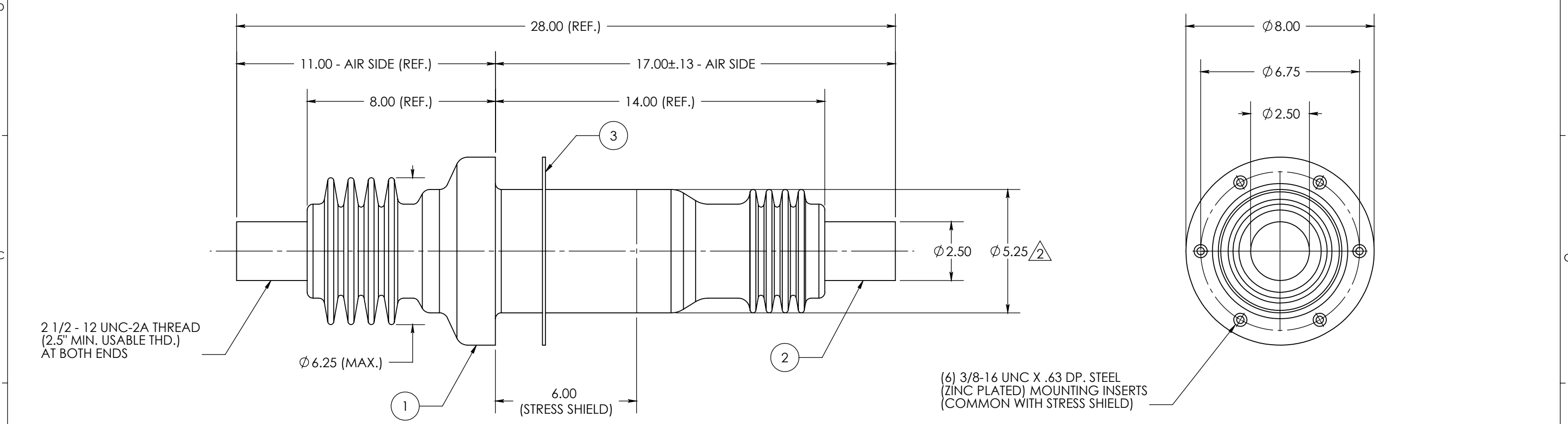

NOTES:
 1. ALL CONTACT SURFACES TO BE CLEAN & FREE FROM FLASH

MATERIAL:
 1. E07 - CYCLOALIPHATIC EPOXY (U.V. EXPOSED), COLOR: GREY
 2. HD ETP COPPER C11000, TIN PLATED - CONDUCTOR

SPECIFICATIONS:
 1. MANUFACTURED IN ACCORDANCE WITH IEC 137-1995, CAN/CSA-C88.1-96, IEEE C57.19.01-1991
 2. RATED VOLTAGE 15kV
 3. POWER FREQUENCY WITHSTAND 50kV
 4. BASIC IMPULSE LEVEL 110kV
 5. NOMINAL CURRENT RATING 3000 AMPS
 6. TEMPERATURE CLASSIFICATION..... -50°C TO +105°C
 7. APPROXIMATE WEIGHT 69 LBS

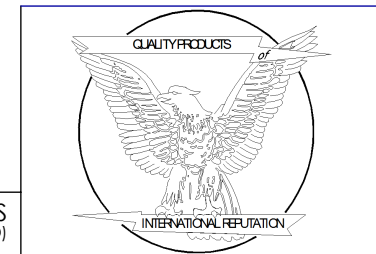
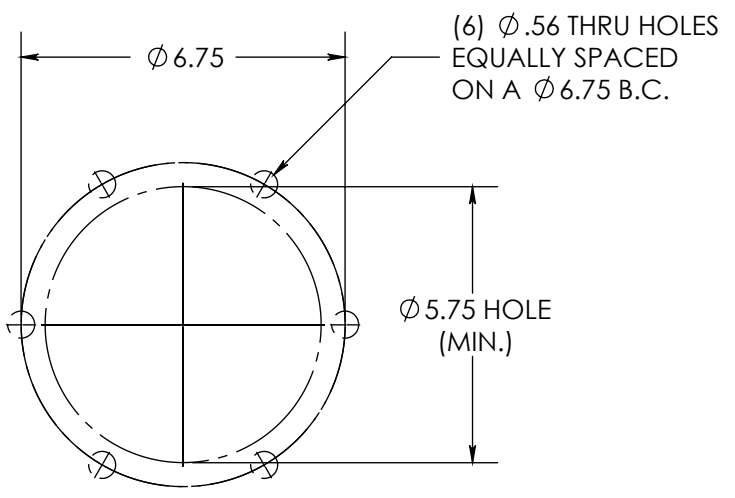

H-J INTERNATIONAL, INC.
 3010 HIGH RIDGE BLVD, HIGH RIDGE, MO. 63049 USA
 PHONE 1-636-677-3421 FAX 1-636-376-1915

15kV / 3000A
 POWER APPARATUS BUSHING

PROPRIETARY AND CONFIDENTIAL
 THE INFORMATION CONTAINED IN THIS DRAWING IS THE SOLE PROPERTY OF H-J INTERNATIONAL, INC. ANY REPRODUCTION IN PART OR AS A WHOLE WITHOUT THE WRITTEN PERMISSION OF H-J INTERNATIONAL, INC. IS STRICTLY PROHIBITED.

BREAK ALL SHARPS UNLESS OTHERWISE NOTED

TOLERANCES (EXCEPT AS NOTED)	
ONE PLACE MM	±1.50
TWO PLACE MM	±0.75
TWO PLACE DEC.	±.060
THREE PLACE DEC.	±.030
FRACTIONS	± 1/16"
ANGLES	2°

APPROVED BY	DB	DATE	8/12/2003
CHECKED BY	BS	DATE	06/23/2014
DRAWN BY	DB	DATE	8/11/2003
TOOL NO.	T20-200-9		
PRODUCT GRP.	2000 SERIES		

DRAWING NO. 20-200-901			
SCALE	1:4	SIZE	B
REV.	2	SHEET	1 OF 1